

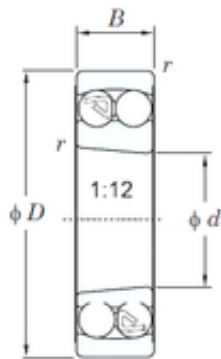

## BEARING DRIVESHAFT, INC.

55 mm x 100 mm x 21 mm KOYO 1211K self aligning ball bearings



Bearing No. 1211K

1211K Bearing 2D drawings and 3D CAD models

Size	55x100x21 mm
Bore Diameter	55 mm
Outer Diameter	100 mm
Width	21 mm
d	55 mm
D	100 mm
B	21 mm
C	21 mm
r min.	1.5 mm
da min.	63 mm
Da max.	92 mm
ra max.	1.5 mm
Weight	0.693 Kg
Basic dynamic load rating (C)	26.8 kN
Basic static load rating (C0)	10.0 kN
(Grease) Lubrication Speed	5800 r/min
(Oil) Lubrication Speed	7100 r/min
Calculation factor (e)	0.20
Calculation factor (Y0)	3.34
Calculation factor (Y1)	3.19
Category	Self Aligning Ball Bearings
Inventory	0.0
Manufacturer Name	KOYO
Minimum Buy Quantity	N/A
Weight / Kilogram	0.749



## BEARING DRIVESHAFT, INC.

EAN	0060579000115
Product Group	B00152
Mounting Method	Tapered Adapter
Enclosure	Open
Rolling Element	Ball Bearing
Adapter Sleeve	H-211X
Cage Material	Steel
Precision Class	ABEC 1   ISO P0
Internal Clearance	C0-Medium
Number of Rows of Balls	Double Row
Other Features	Allowable Misalignment 2.5 Deg   1:12 Taper
Long Description	55MM Bore; Tapered Adapter Mount; 100MM Outside Diameter; 21MM Inner Race Width; 21MM Outer Race Width; Open; Steel Cage; Double Row of Balls; ABEC 1   ISO P0; C0-Medium
Inch - Metric	Metric
Category	Self Aligning Ball Bearings
UNSPSC	31171532
Harmonized Tariff Code	8482.10.50.68
Noun	Bearing
Keyword String	Self Aligning
Manufacturer URL	<a href="http://www.koyousa.com">http://www.koyousa.com</a>
Manufacturer Item Number	1211K
Weight / LBS	1.5278
Bore	2.165 Inch   55 Millimeter
Outside Diameter	3.937 Inch   100 Millimeter
Inner Race Width	0.827 Inch   21 Millimeter
Outer Race Width	0.827 Inch   21 Millimeter