

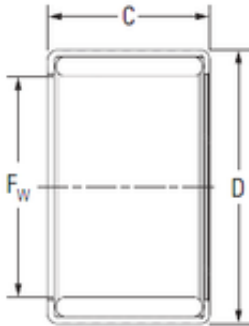

BEARING DRIVESHAFT, INC.

KOYO Y2110 needle roller bearings



Bearing No. Y2110

Size	33.338x41.275x15.88 mm
Bore Diameter	33,338 mm
Outer Diameter	41,275 mm
Width	15,88 mm
Fw	33,338 mm
D	41,275 mm
C	15,88 mm
Weight	0,046 Kg
Basic dynamic load rating (C)	22,6 kN
Basic static load rating (C0)	49,2 kN

Y2110 Bearing 2D drawings and 3D CAD models