

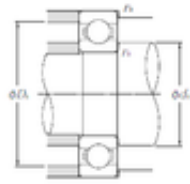

# BEARING DRIVESHAFT, INC.

50 mm x 90 mm x 20 mm NTN 6210LLU deep groove ball bearings

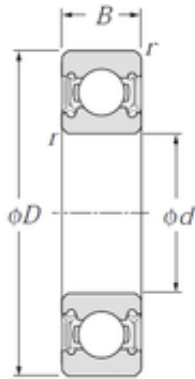

Bearing No. 6210LLU

6210LLU Bearing 2D drawings and 3D CAD models

Size	50x90x20 mm
Bore Diameter	50 mm
Outer Diameter	90 mm
Width	20 mm
d	50 mm
D	90 mm
B	20 mm
C	20 mm
r min.	1,1 mm
da min.	56,5 mm
da max	60 mm
Da max.	83,5 mm
ra max.	1 mm
Weight	0,454 Kg
Basic dynamic load rating (C)	35 kN
Basic static load rating (C0)	23,2 kN
Reference speed	4 700 r/min
Category	Single Row Ball Bearings
Inventory	0.0
Manufacturer Name	NTN
Minimum Buy Quantity	N/A
Weight / Kilogram	0
EAN	4547359004786
Product Group	B00308
Enclosure	2 Seals



## BEARING DRIVESHAFT, INC.

Precision Class	ABEC 1   ISO P0
Maximum Capacity / Filling Slot	No
Rolling Element	Ball Bearing
Snap Ring	No
Internal Special Features	No
Cage Material	Steel
Enclosure Type	Contact Seal
Internal Clearance	C0-Medium
Inch - Metric	Metric
Long Description	50MM Bore; 90MM Outside Diameter; 20MM Outer Race Width; 2 Seals; Ball Bearing; ABEC 1   ISO P0; No Filling Slot; No Snap Ring; No Internal Special Features; C0-Medium Internal Clearance; Steel Cage;
Other Features	Deep Groove   Double Lip Friction Nitrile Rubber Seal   -20 To 120 Deg C
Category	Single Row Ball Bearing
UNSPSC	31171504
Harmonized Tariff Code	8482.10.50.68
Noun	Bearing
Keyword String	Ball
Manufacturer URL	<a href="http://www.ntnamerica.com">http://www.ntnamerica.com</a>
Manufacturer Item Number	6210LLU
Weight / LBS	1.01
Outside Diameter	3.543 Inch   90 Millimeter
Inner Race Width	0 Inch   0 Millimeter
Outer Race Width	0.787 Inch   20 Millimeter
Bore	1.969 Inch   50 Millimeter
bore diameter:	50 mm



## BEARING DRIVESHAFT, INC.

precision rating:	ISO Class 0
outside diameter:	90 mm
finish/coating:	Uncoated
overall width:	20 mm
bearing material:	High Carbon Chrome Steel
bore type:	Round
cage material:	Steel
closure type:	Double Sealed
inner ring width:	20 mm
row type & fill slot:	Single Row Non-Fill Slot
outer ring width:	20 mm
snap ring included:	Without Snap Ring
maximum rpm (grease):	4700 rpm
internal clearance:	CN
fillet radius:	1.1 mm
operating temperature range:	-40 to 120 ° C
maximum rpm:	8300 RPM
dynamic load capacity:	35000 N
series:	62
static load capacity:	23200 N
manufacturer product page:	<a href="#">Click here</a>