

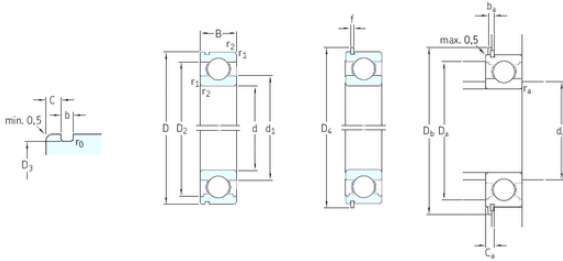

BEARING DRIVESHAFT, INC.



50 mm x 90 mm x 20 mm SKF 6210N deep groove ball bearings

Bearing No. 6210N

6210N Bearing 2D drawings and 3D CAD models

Size	50x90x20 mm
Bore Diameter	50 mm
Outer Diameter	90 mm
Width	20 mm
d	50 mm
D	90 mm
B	20 mm
C	20 mm
b	2,7 mm
d1	62,5 mm
r0 max.	0,6 mm
r1 min.	1,1 mm
r2 min.	1,1 mm
C	3,28 mm
D2	81,7 mm
D3	86,79 mm
D4	96,5 mm
Ca max.	5,74 mm
da min.	3 mm
da max	57 mm
Da max.	83 mm
Db min.	98 mm
ra max.	1 mm
Weight	0,47 Kg
Basic dynamic load rating (C)	37,1 kN



BEARING DRIVESHAFT, INC.

Basic static load rating (C ₀)	23,2 kN
Fatigue load limit (P _u)	0,98
Reference speed	15000 r/min
Limiting speed	10000 r/min
Calculation factor (f ₀)	14