

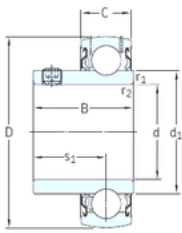

# BEARING DRIVESHAFT, INC.

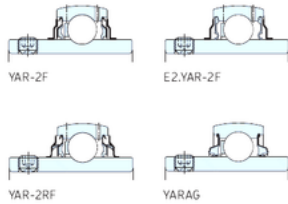

YAT



68,263 mm x 120 mm x 68,3 mm SKF  
YAR213-211-2F deep groove ball bearings

Bearing No. YAR213-211-2F

Size	68.263x120x68.3 mm
Bore Diameter	68,263 mm
Outer Diameter	120 mm
Width	68,3 mm
d	68,263 mm
D	120 mm
B	68,3 mm
C	27 mm
d1	82,5 mm
r1 min.	1,5 mm
r2 min.	1,5 mm
s1	42,9 mm
Weight	1,7 Kg
Basic dynamic load rating (C)	57,2 kN
Basic static load rating (C0)	40 kN
Fatigue load limit (Pu)	1,7

YAR213-211-2F Bearing 2D drawings and 3D CAD models