

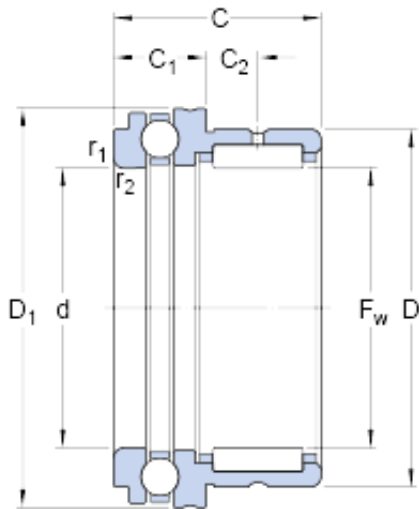

# BEARING DRIVESHAFT, INC.

## SKF NKX 50 cylindrical roller bearings

Bearing No. NKX 50



NKX 50 Bearing 2D drawings and 3D CAD models

Size	62x50x35 mm
Bore Diameter	62 mm
Outer Diameter	50 mm
Width	35 mm
$F_w$	50 mm
D	62 mm
C	35 mm
$C_1$	14 mm
$C_2$	10 mm
d	50 mm
$D_1$	70.2 mm
$r_{1,2}$ - min.	0.6 mm
$d_a$ - min.	65.5 mm
$r_a$ - max.	0.6 mm
$r_b$ - max.	0.6 mm
$d_i$	45 mm
F	50 mm
$B_i$	25 mm
Basic dynamic load rating, radial direction - C	38 kN
Basic static load rating, radial direction - $C_0$	78 kN
Basic dynamic load rating, axial direction - C	28.6 kN
Basic static load rating, axial direction - $C_0$	81.5 kN



## BEARING DRIVESHAFT, INC.

Fatigue load limit, radial direction - $P_u$	9.6 kN
Fatigue load limit, axial direction - $P_u$	3 kN
Reference speed	4300 r/min
Limiting speed	6300 r/min
Mass bearing	0.28 kg
Category	Roller Bearings
Inventory	0.0
Manufacturer Name	SKF
Minimum Buy Quantity	N/A
Weight / Kilogram	0.298
EAN	7316577027894
Product Group	B04144
bore diameter:	50 mm
dynamic load capacity:	38 kN
outside diameter:	62 mm
static load capacity:	78 kN
overall width:	35 mm
maximum rpm:	6300 rpm
needle bearing type:	Roller & Cage Assembly
flanges:	No Flange
closure type:	Open
series:	NKX
number of rows:	One
lubrication hole type:	Hole on Outer Ring
bearing material:	Steel
precision rating:	Not Rated
operating temperature range:	Maximum of +250 ° F ° F
manufacturer upc number:	7316577027894
cage material:	Steel
$F_w$	50 mm



## BEARING DRIVESHAFT, INC.

$C_1$	14 mm
$C_2$	10 mm
$D_1$	70.2 mm
$r_{1,2}$ min.	0.6 mm
$d_a$ min.	65.5 mm
$r_a$ max.	0.6 mm
$r_b$ max.	0.6 mm
$d_i$	45 mm
$B_i$	25 mm
Basic dynamic load rating, radial direction C	38 kN
Basic static load rating, radial direction $C_0$	78 kN
Basic dynamic load rating, axial direction C	28.6 kN
Basic static load rating, axial direction $C_0$	81.5 kN
Fatigue load limit, radial direction $P_u$	9.65 kN
Fatigue load limit, axial direction $P_u$	3.05 kN
Minimum axial load factor A	0.034
Inner ring	IR 45x50x25