

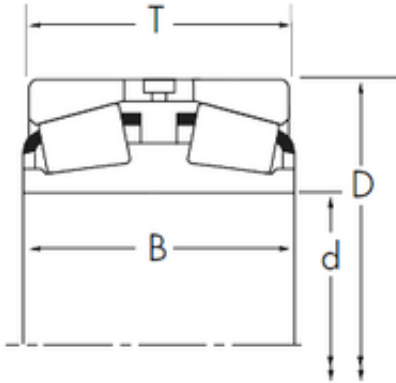

BEARING DRIVESHAFT, INC.

304,8 mm x 495,3 mm x 165,1 mm Timken
EE724121D/724195+Y1S-724195 tapered roller
bearings



Bearing No. EE724121D/724195+Y1S-724195

Size	304.8x495.3x171.45 mm
Bore Diameter	304,8 mm
Outer Diameter	495,3 mm
Width	171,45 mm
d	304,8 mm
D	495,3 mm
T	171,45 mm
B	165,1 mm
R	3,3 mm
r	6,4 mm

EE724121D/724195+Y1S-724195 Bearing 2D drawings
and 3D CAD models